

Adjusting the tension on the rotator

Using an 1/8" allen wrench, remove these 2 screws (screws are identical)



Step 1

Using an 1/8" allen wrench, remove these 2 screws there is a spring behind this plate, (see exploded view) remove plate slowly (screws are different lengths)



Step 2

Using a 3/32" allen wrench, turn this set screw clockwise \rightarrow 1/8" turn at a time until tension is felt when rotating (set screw is in middle hole of the 3 holes) *maximum of (1) 1/8" turn from when tension is felt or bracket will be damaged

Enlarged View



Step 3

Detent (round end in first)

Rotator

Spring

Spacer

\rightarrow longer screw must be in this location

Base

Bottom Plate

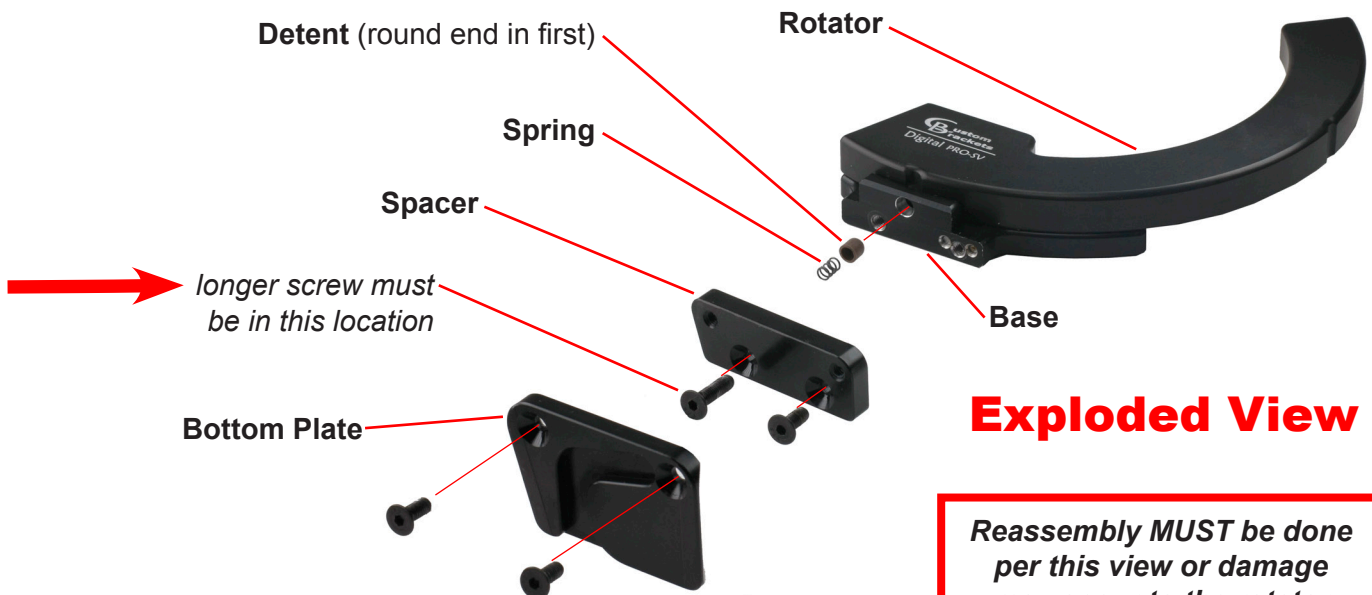

Exploded View

Reassembly **MUST** be done per this view or damage may occur to the rotator